

FLOOR PLAN

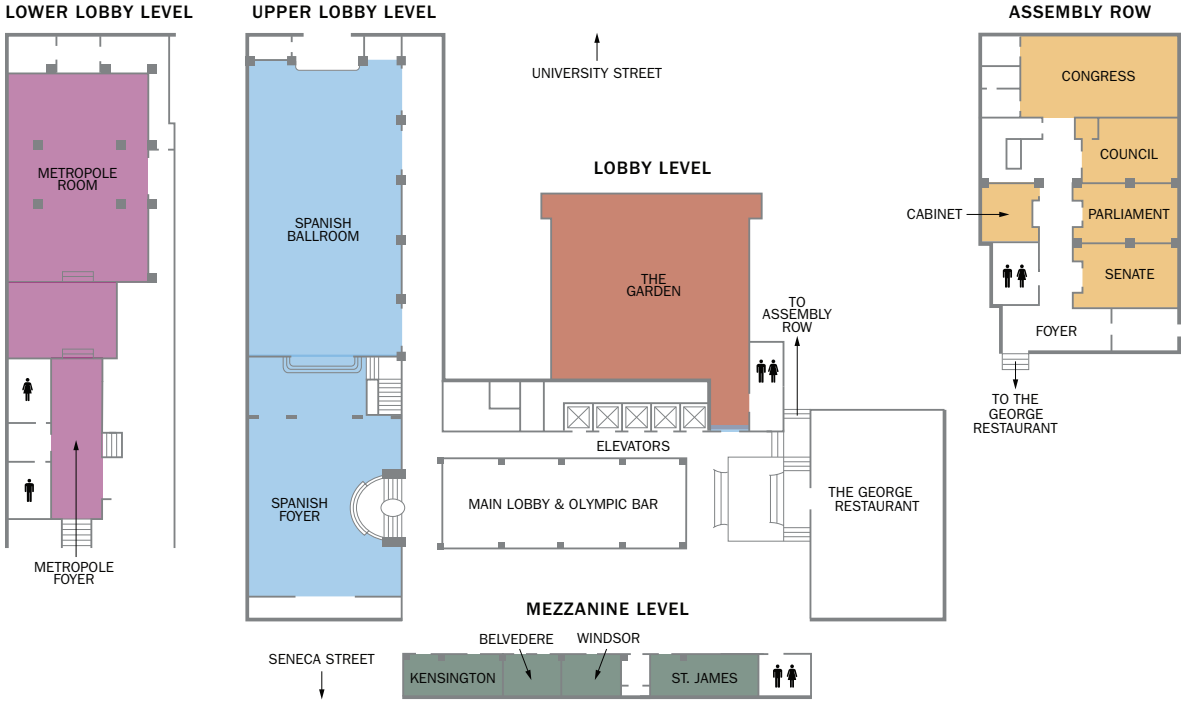

CAPACITY CHART

	OVERALL DIMENSIONS		SQUARE		HEIGHT		CAPACITIES							
	FEET	METERS	FEET	METERS	FEET	METERS	CLASSROOM	THEATER	RECEPTION	BANQUET	CRESCENT ROUNDS OF 7	CONFERENCE	U-SHAPE	
UPPER LOBBY LEVEL														
SPANISH BALLROOM	47' x 109'	14.3 x 33.2	5,123	476	20'	6.1	280	580	650	480	336	65	50	
SPANISH FOYER	46' x 99'	14.0 x 30.2	4,554	423	22'	6.7	-	-	350	150	-	-	-	
LOBBY LEVEL														
THE GARDEN	68' x 75'	20.7 x 22.9	5,100	474	31'	9.4	200	-	200	230	119	-	-	
LOWER LOBBY LEVEL														
METROPOLE FOYER	16' x 52'	4.8 x 15.8	832	77	10'2"	3.1	-	-	75	-	-	-	-	
METROPOLE ROOM	48' x 64'	14.6 x 19.5	3,072	285	13'7"	3.9	120	300	350	300	175	65	60	
MEZZANINE LEVEL														
BELVEDERE	16' x 21'	4.9 x 6.4	336	31	14'	4.3	-	20	30	20	-	16	-	
KENSINGTON	16' x 34'	4.9 x 10.4	544	51	14'	4.3	-	40	40	30	-	25	-	
ST. JAMES	16' x 32'	4.9 x 9.8	512	48	14'	4.3	-	-	-	-	-	16	-	
WINDSOR	16' x 22'	4.9 x 6.7	352	33	14'	4.3	-	-	-	-	-	10	-	
ASSEMBLY ROW														
CABINET	16' x 20'	4.9 x 6.1	320	30	11'	3.4	-	-	-	-	-	10	-	
CONGRESS	29' x 55'	8.8 x 16.8	1,595	148	11'	3.4	96	150	150	130	91	45	40	
COUNCIL	20' x 33'	6.1 x 10.1	660	61	11'	3.4	30	60	50	40	28	25	20	
PARLIAMENT	21' x 32'	6.4 x 9.8	672	62	11'	3.4	32	70	60	50	35	30	25	
SENATE	21' x 32'	6.4 x 9.8	672	62	11'	3.4	32	70	60	50	35	30	25	



SCAN QR CODE
TO LEARN MORE



Fairmont Olympic Hotel
411 University Street
Seattle, Washington
United States 98101

T +1 206 621 1700
F +1 206 682 9633
olympic@fairmont.com
fairmontolympic.com

Fairmont
OLYMPIC HOTEL